

Manhole cover with sight glass

to be mounted similar to DIN 28120

(Hand hole, Inspection flange)



Bauform 1205

Application:

By using the integrated sight glass you save a further hole in the vessel.

The fittings shows two functions: a) Compression res. Sight glass
b) Man hole service opening etc.

Operating conditions:

Working pressure: by agreement

Working temperature: 150°C or 280°C

Options:

Base flanges to be welded

Safety seal-system acc. to DIN 28121

Wiper

Spray washer

Sight glass light fittings

Materials:

Base and cover flanges	Steel or Stainless steel
------------------------	--------------------------

Glass	Borosilicate glass DIN 7080 Soda-lime-Glas DIN 8902
-------	--

Dimensions:

DN 150 to DN 800

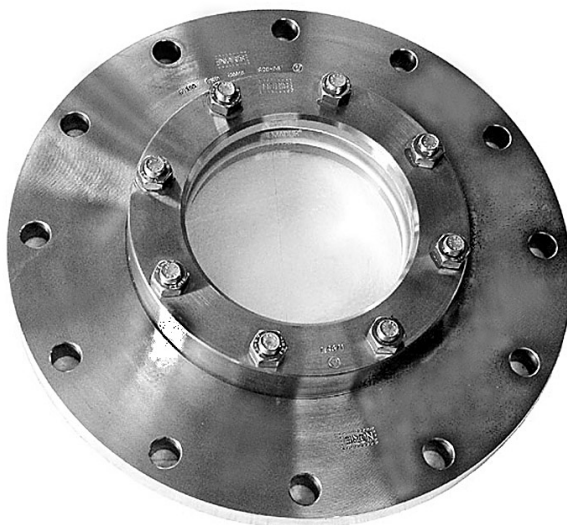
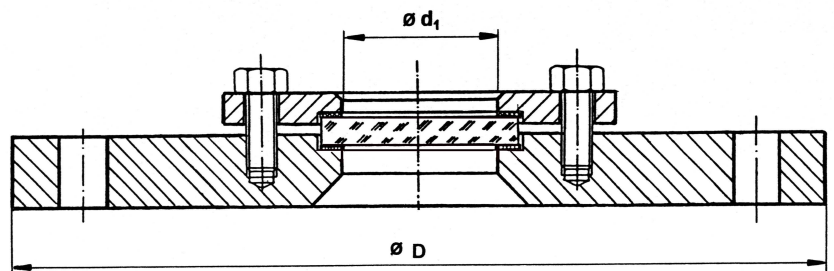

Modifications reserved



AVEMAR CZECH s.r.o. | speciální armatury pro měření a regulaci |
Branch office | Lihovarská 1199/10 | 716 03 Ostrava - Radvanice | Česká republika |
Tel.: +420 596 232 996 (7) | Fax: +420 596 232 998 | www.avemar.cz | avemar@avemar.cz |